



AQUATEC
INSTRUKCJA MONTAŻU



| 480186531 |

BATERIA PRYSZNICOWA
ROUND JEDNODROŻNA
MIESZACZOWA - ELEMENT
ZEWNĘTRZNY - DO
MODUŁU COREBOX

Zakres ciśnień min/max 0,5/5 barów (w przypadku ciśnienia wody wyższego niż 5 barów zalecamy zamontowanie reduktorów ciśnienia. Zalecane ciśnienie: 3 bary.

Operacja:
Z gazowymi lub elektrycznymi kotłami akumulacyjnymi.
Scentralizowane systemy.

Pressure range min/max 0,5/5 bar (in case of water pressure higher than 5 bar we recommend installing pressure reducers).
Recommended pressure 3 bar.

Operation:
Either with gas or electric accumulation boilers.
Centralised systems.

Blokada bezpieczeństwa przy: 38°
Min. Temperatura pracy: 3°C
Min. Zalecana temperatura: 15°C
Max. Temperatura pracy: 70°C
Max. Zalecana temperatura: 65°C
Zalecana różnica temperatur: 50°C

Safety lock at: 38°
Min. Working temperature: 3°C
Min. recommended temperature: 15°C
Max. Working temperature: 70°C
Max. recommended temperature: 65°C
Recommended thermal differential: 50°C

Dezynfekcja termiczna jest dozwolona.
System bezpieczeństwa zatrzyma przepływ w przypadku braku jednego z dwóch dopływów

Thermal disinfection is allowed.
Safety system with flow stop in case of lack of one of the two waters.

Uwaga: Skontaktuj się z hydraulikiem w sprawie wyboru najlepszego urządzenia do podgrzewania wody.

Warning: contact the plumber for the choice of the best water heating device.

Ciężnienie

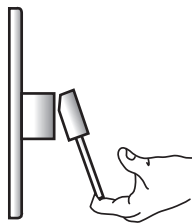
TABELA PRZEPIŁYWÓW (L/min)**Bateria z mieszaczem, 1-drożna****1-drożna**

bar

0,5

10,7

1

15,3

2

21,8

3

26,8

4

31

5

34,8

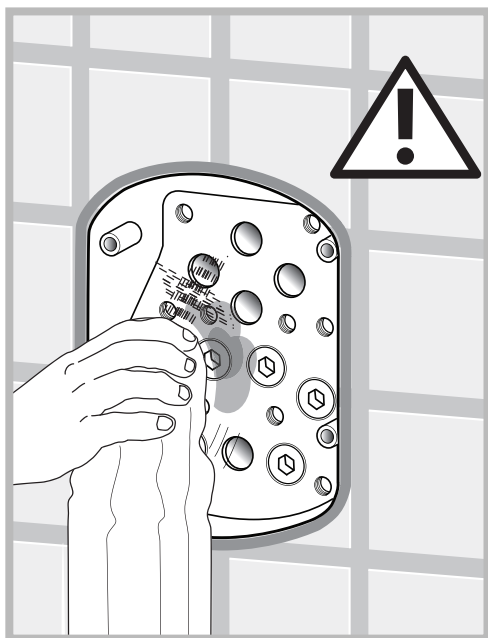
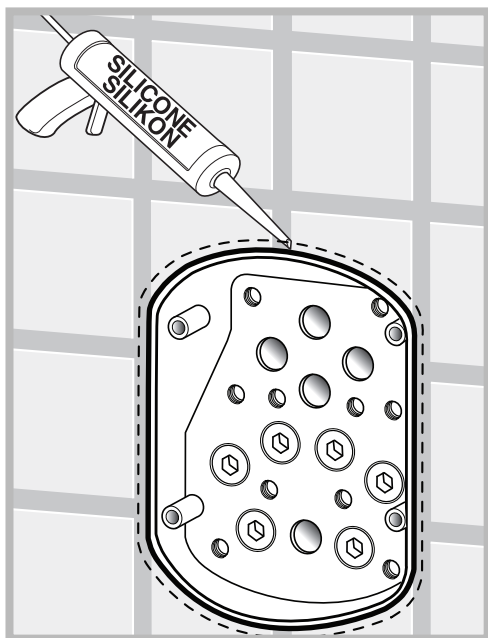
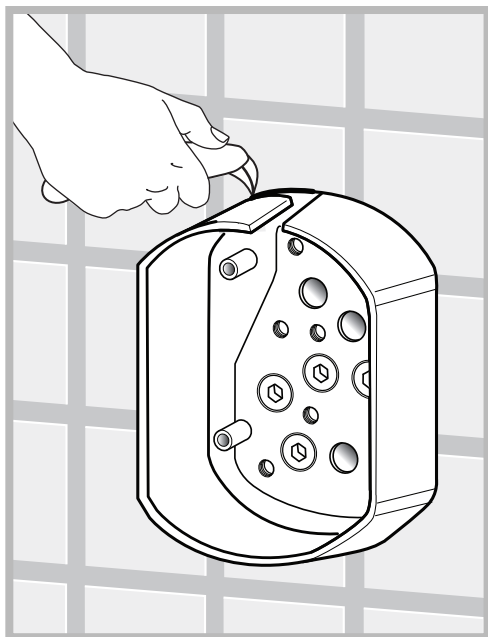
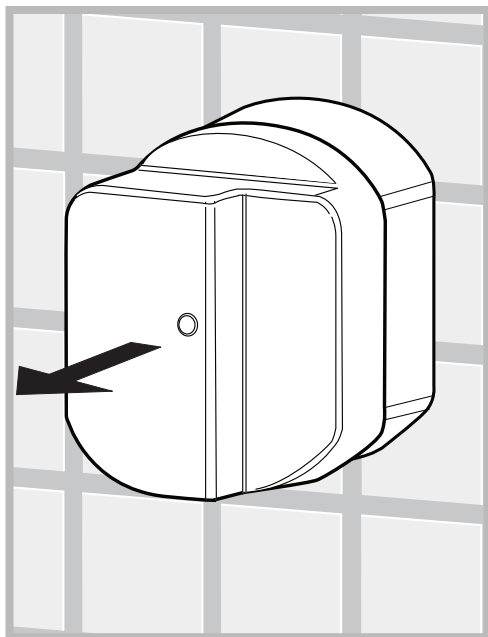

5

ZAWARTOŚĆ PACZKI PACKAGE CONTENT

Bateria z mieszaczem, 1-drożna MIX 1 WAY

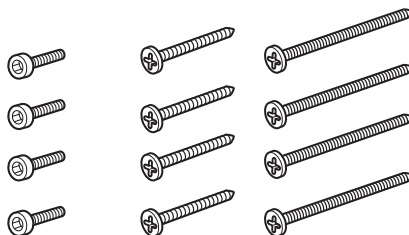
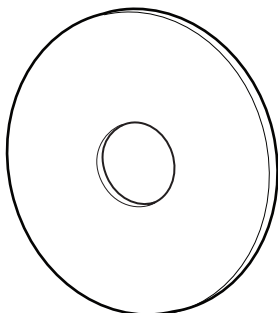
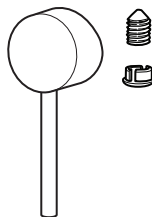
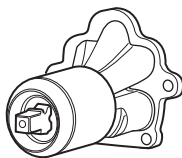
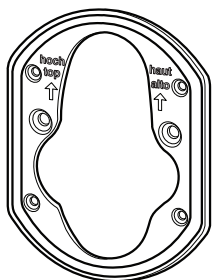

PL Instrukcja montażu
GB Mounting instructions



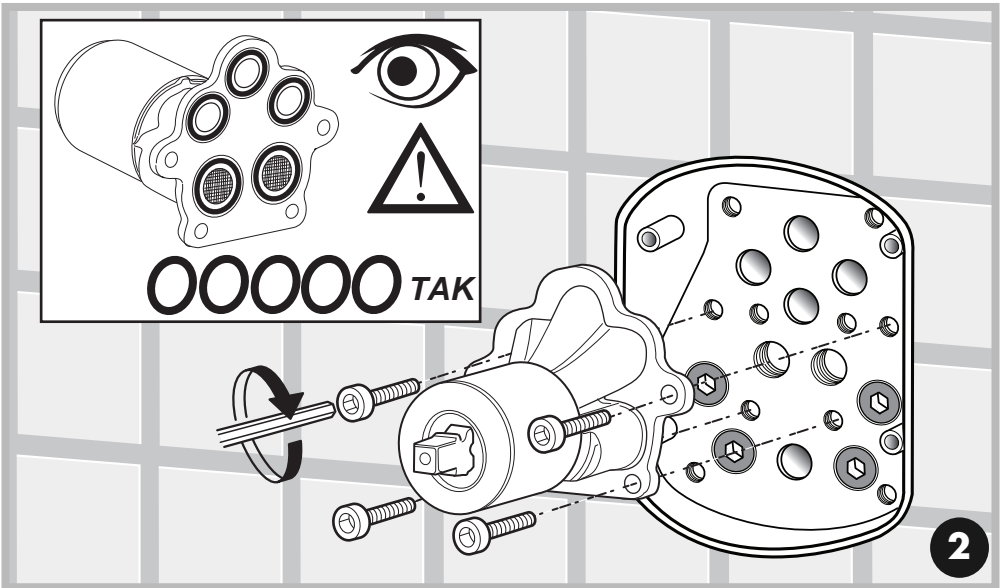
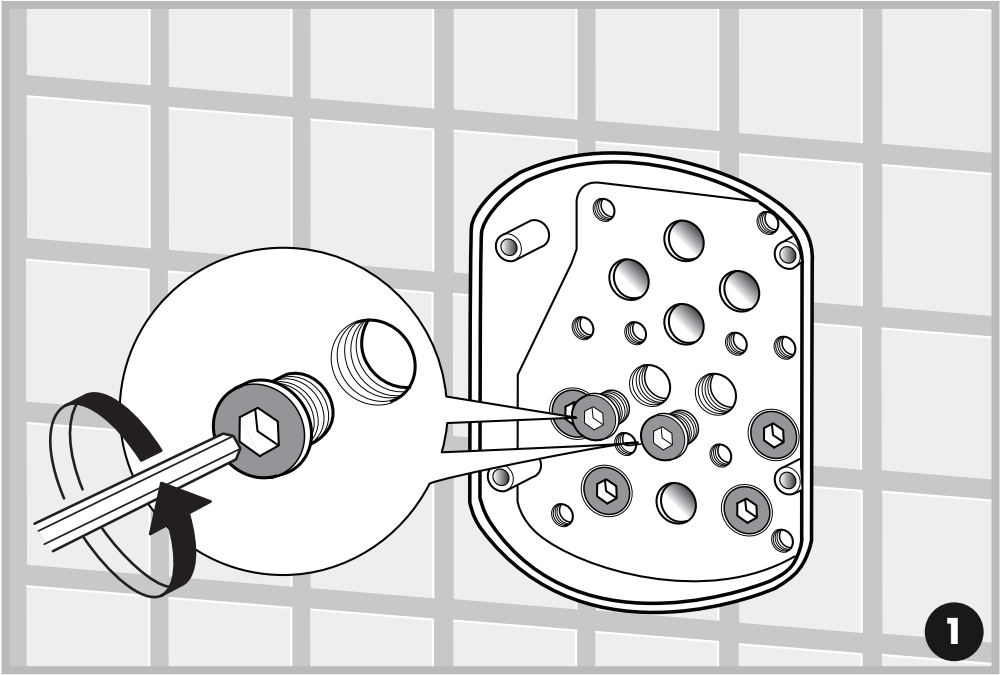

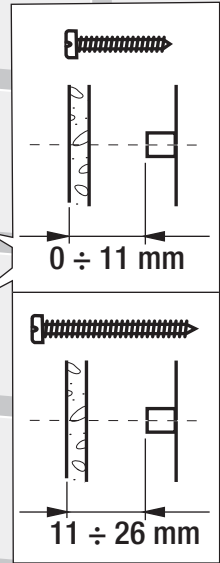
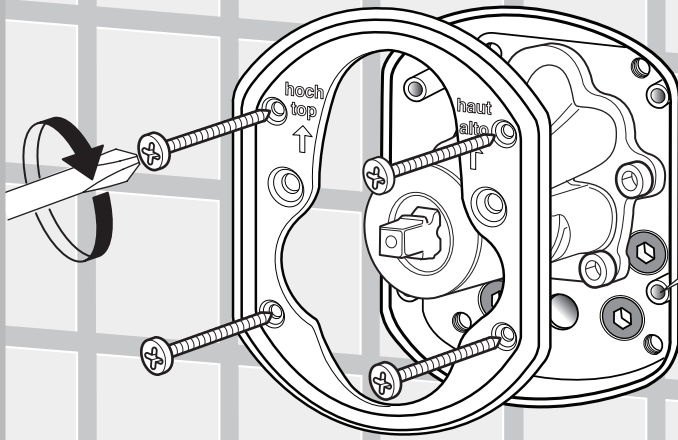

3

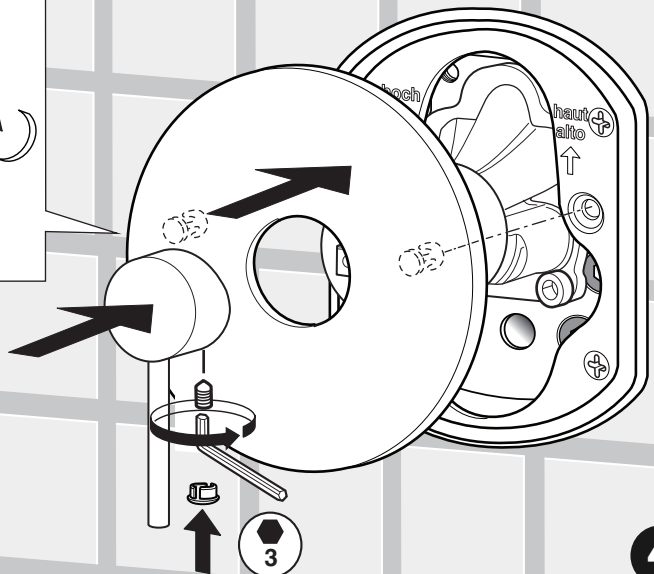
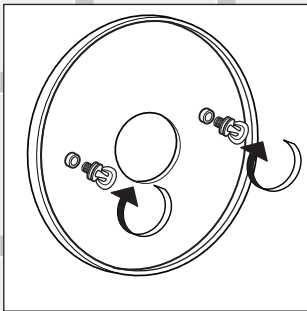

4

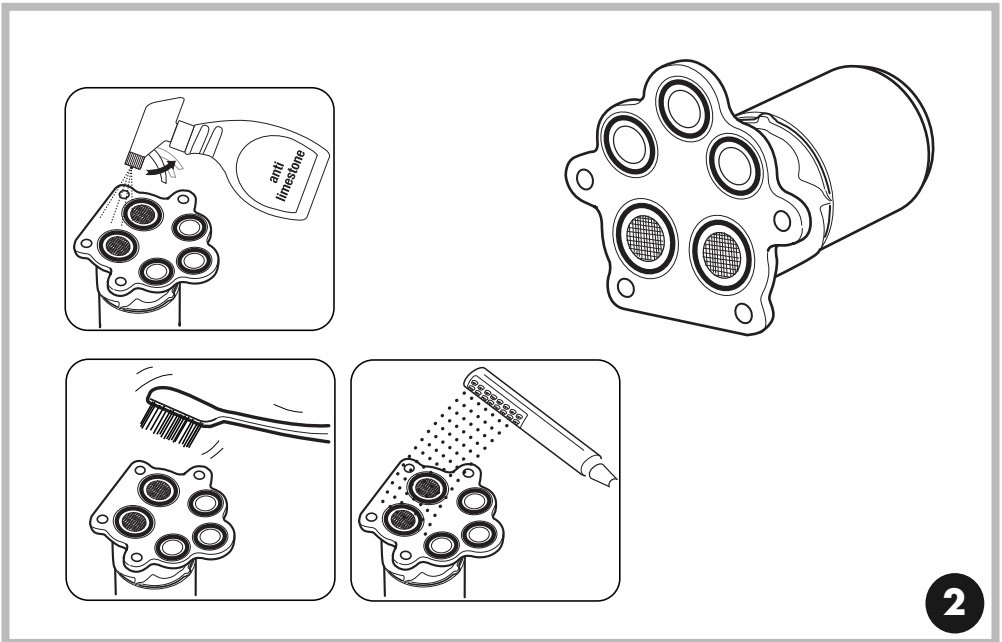
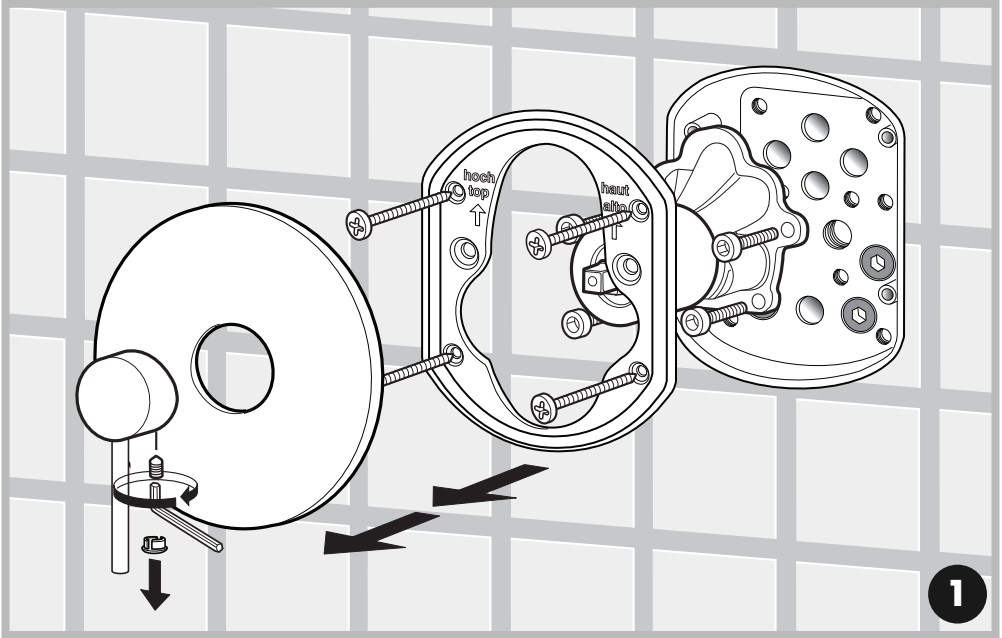

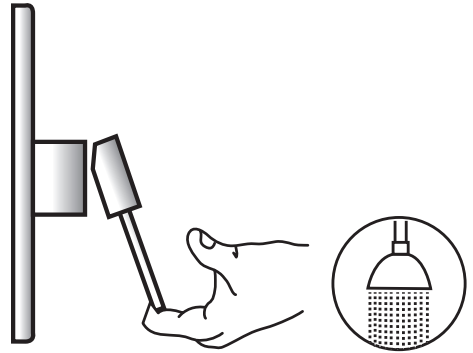
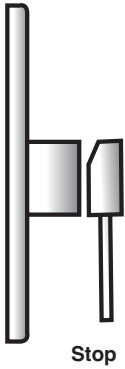
MIESZACZ 1-DROŻNY
MIX 1 WAY



A Q U A T E C

Design & Production

*ul. Golęcińska 36
62-090, Rokietnica*

tel. +48 504 383 264

tel. +48 790 357 888

e-mail : info@aquatec.pl

www.aquatec.pl